

Location

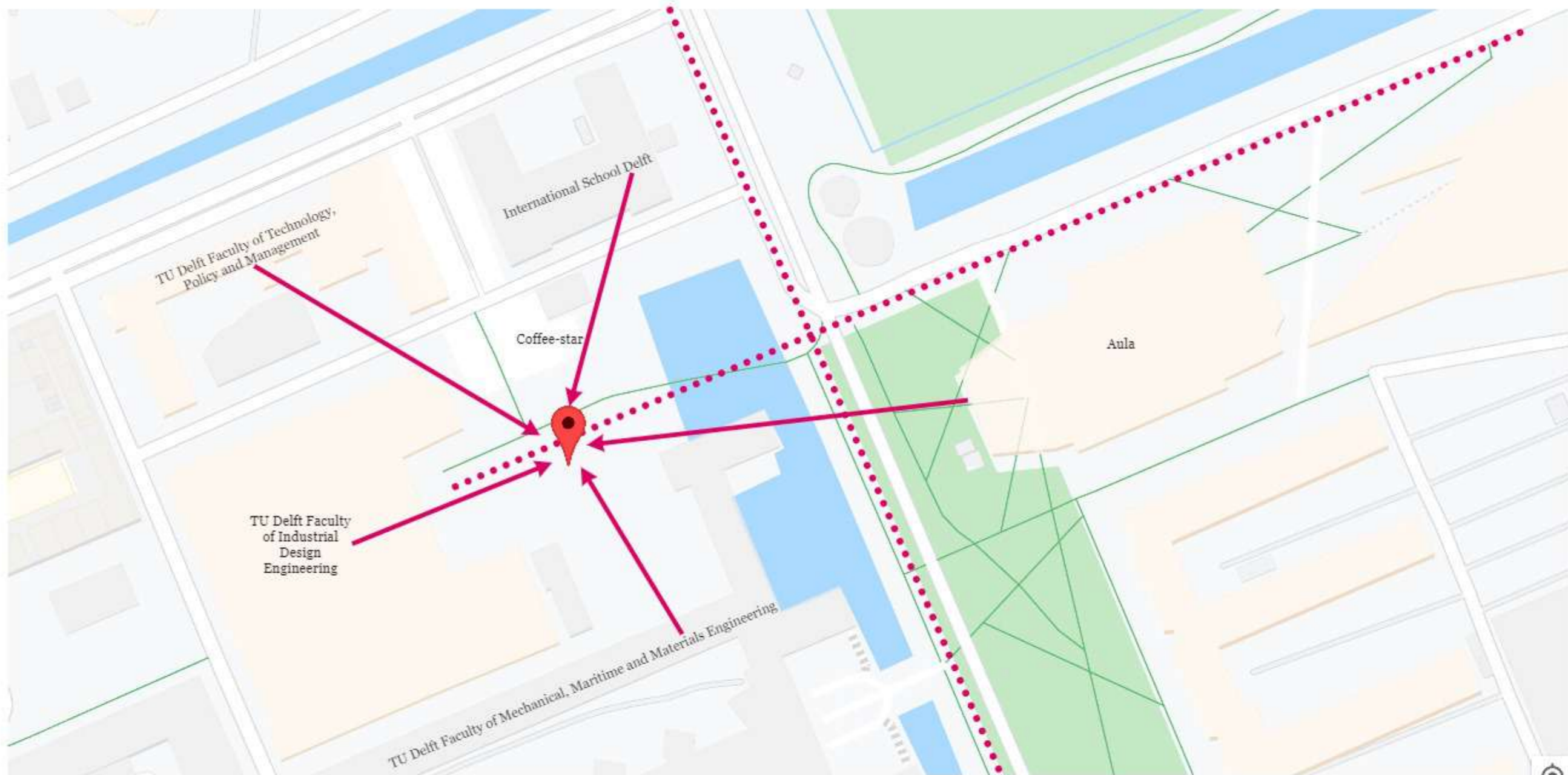

Why?





During the evening the whole space is empty. There is no reason to be there.



The square has a pedestrian function and people have no place to sit



good location in the heart of campus and openness encourage interaction with the space



The visible axes of the site makes the square a central communication point.  
Another advantage is the nearby cafes and food trucks

---

## Pros and cons

# How can we add to this place?



CREATE SPACES TO SIT



SPASES TO READ



TO DRINK COFFEE AND EAT



TO CHARGE LAPTOP AND  
WORK



TO CHILL WITH FRIENDS

TO EXPLORE SURROUNDING



TO PLAY

---

Added value

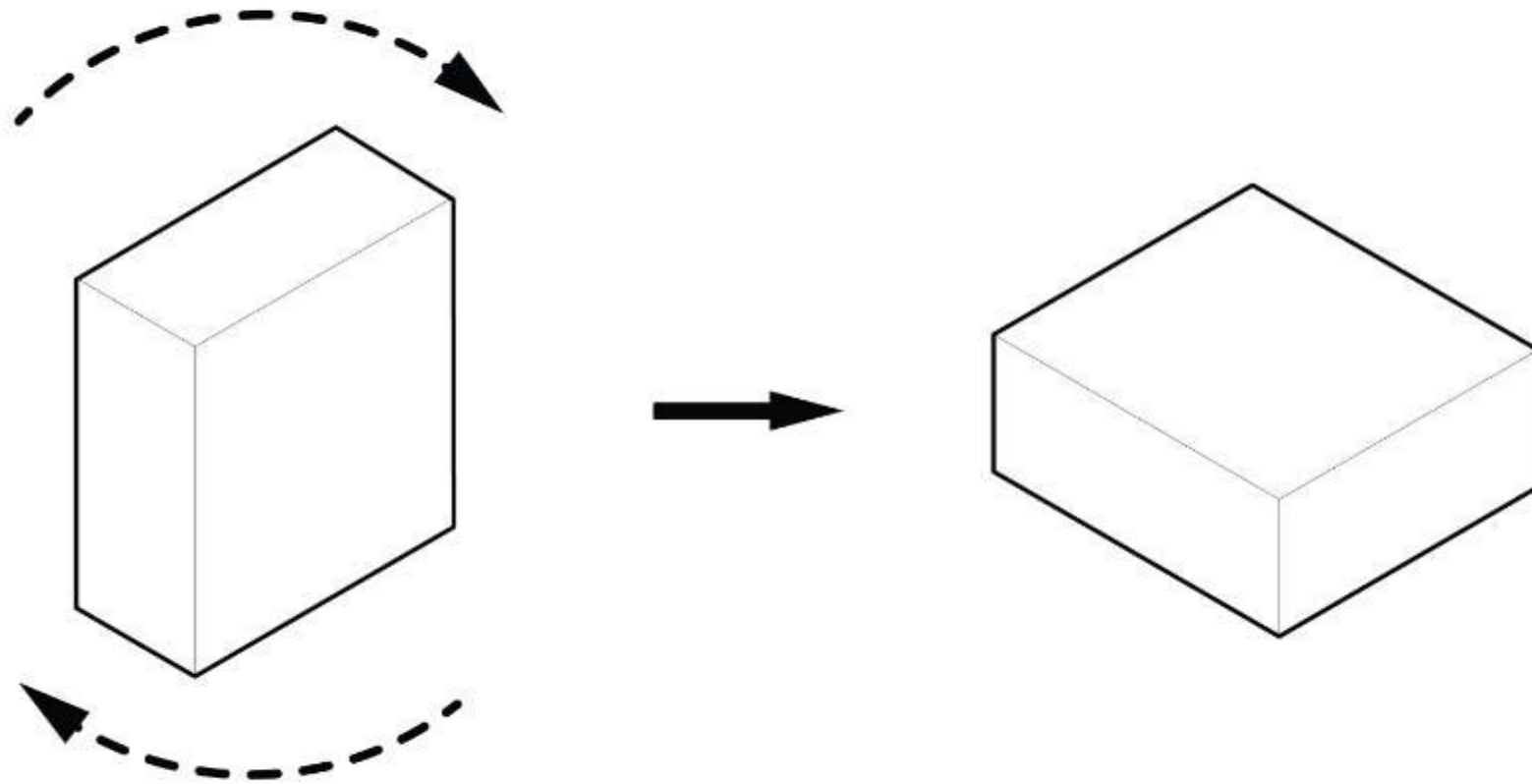

---

Concept Process: Wall

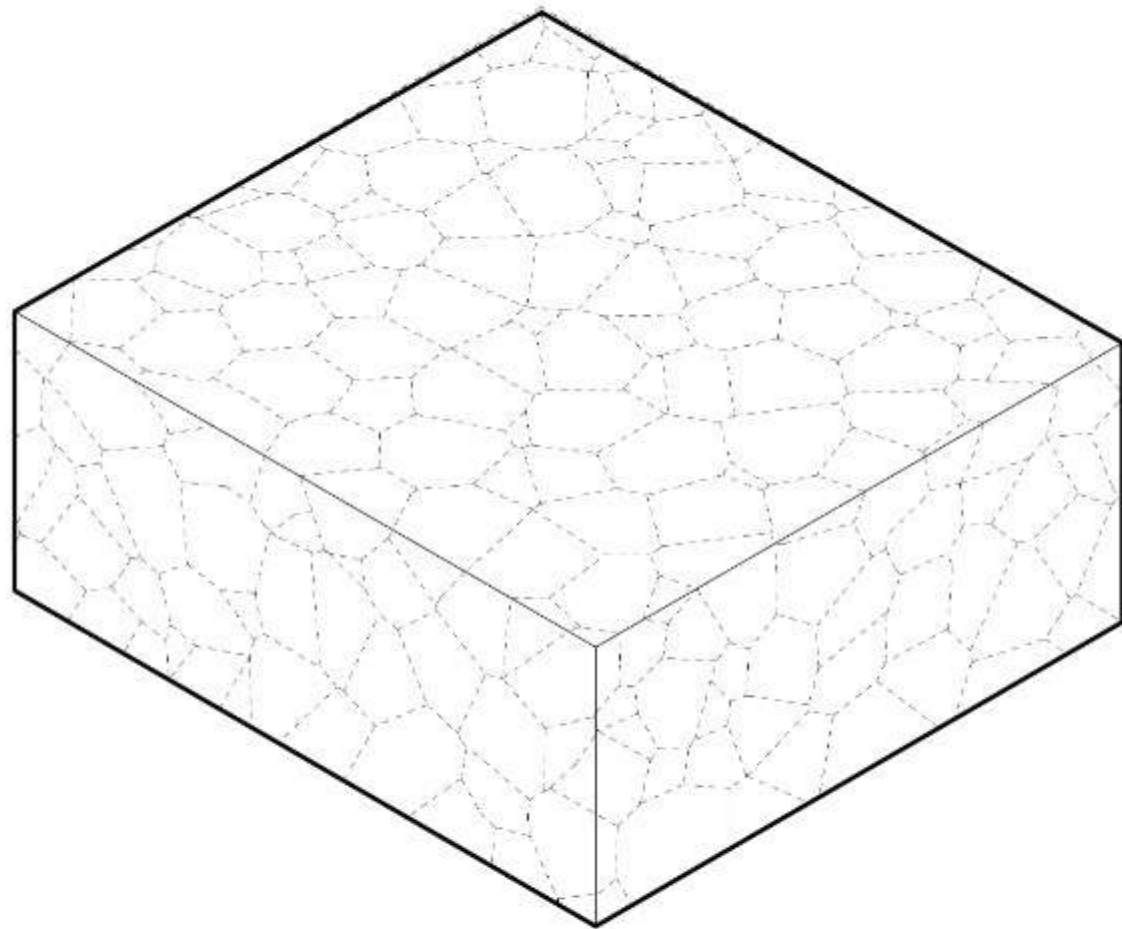

---

Application of Voronoi



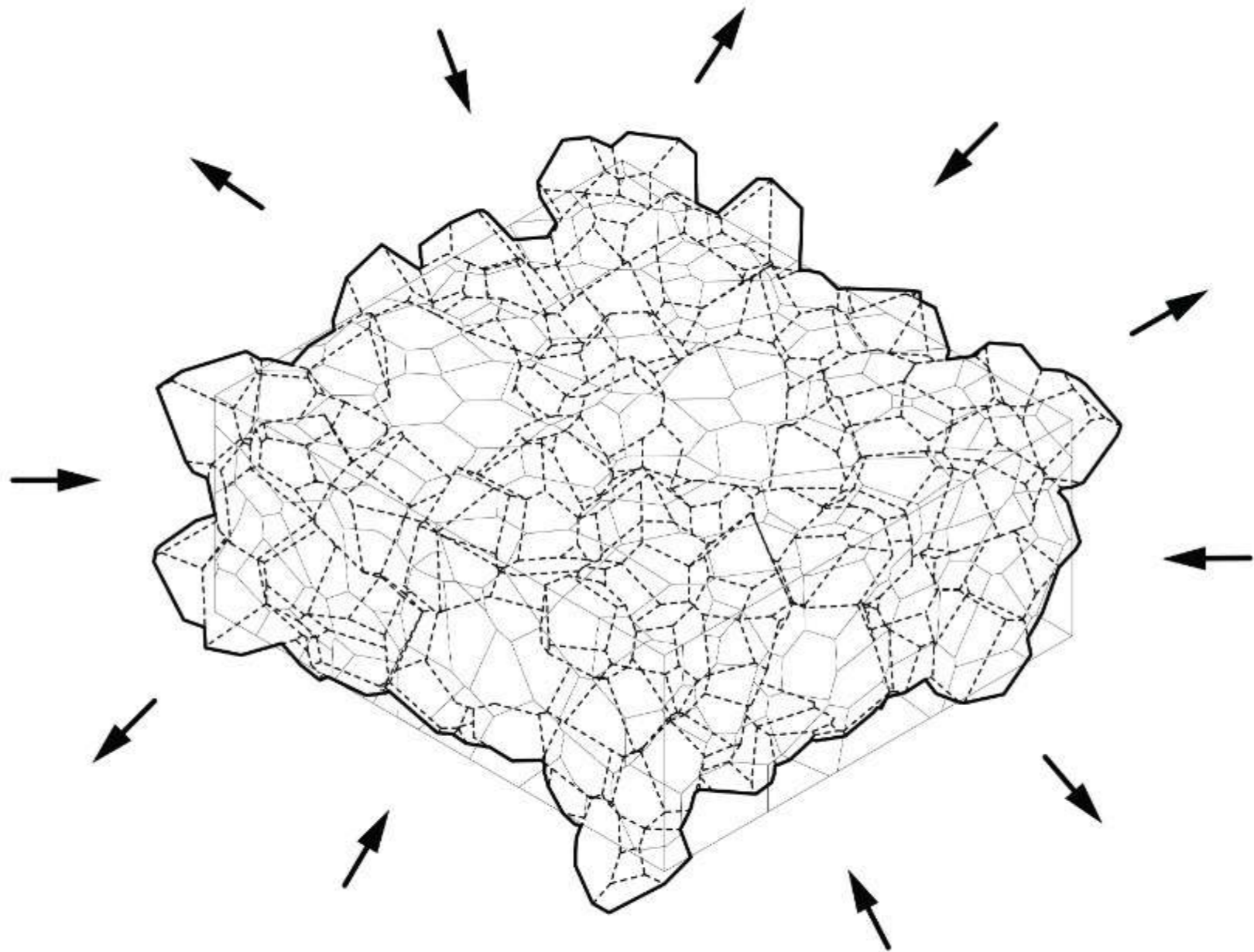

Creation of "Hedgehog"

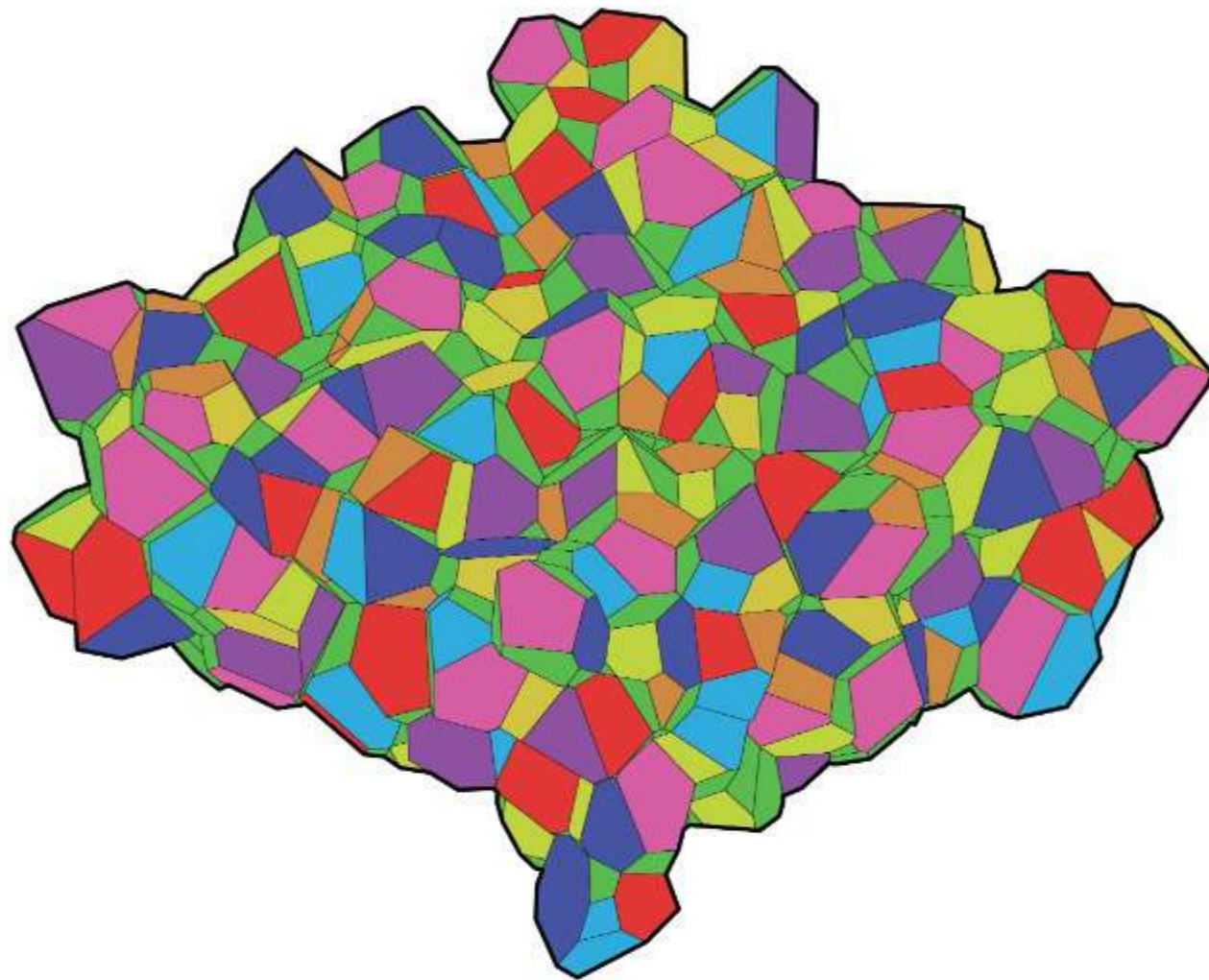

---

Application of Programming & Color



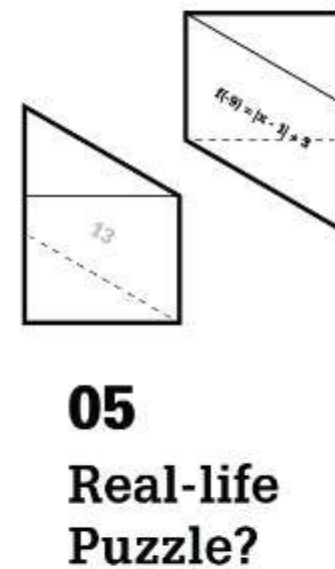
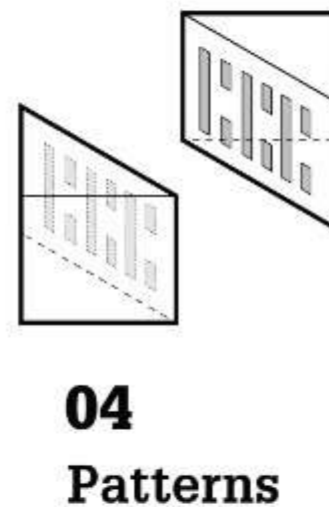
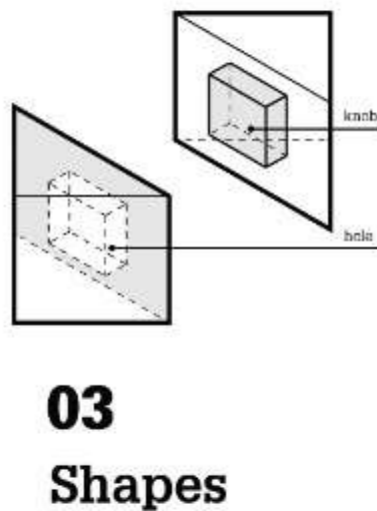
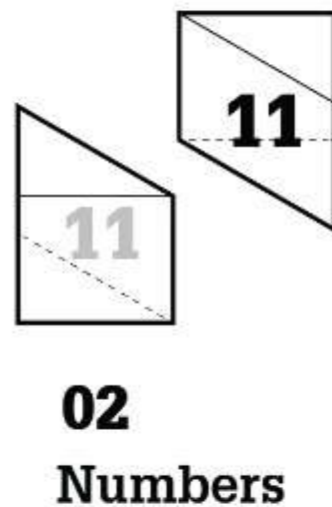
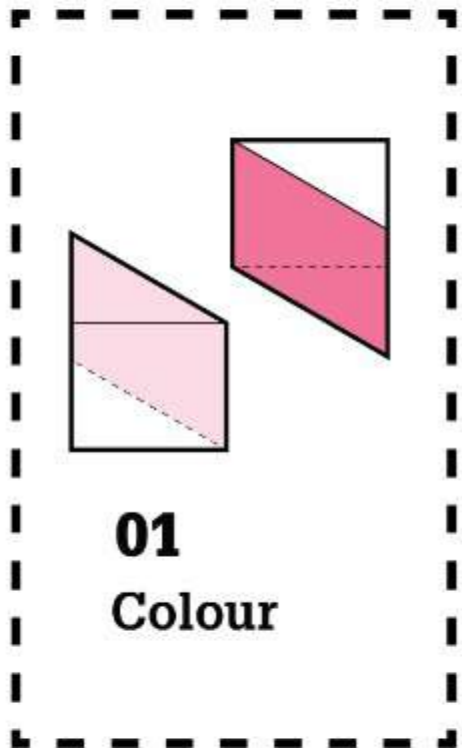

---

Assembly Identification

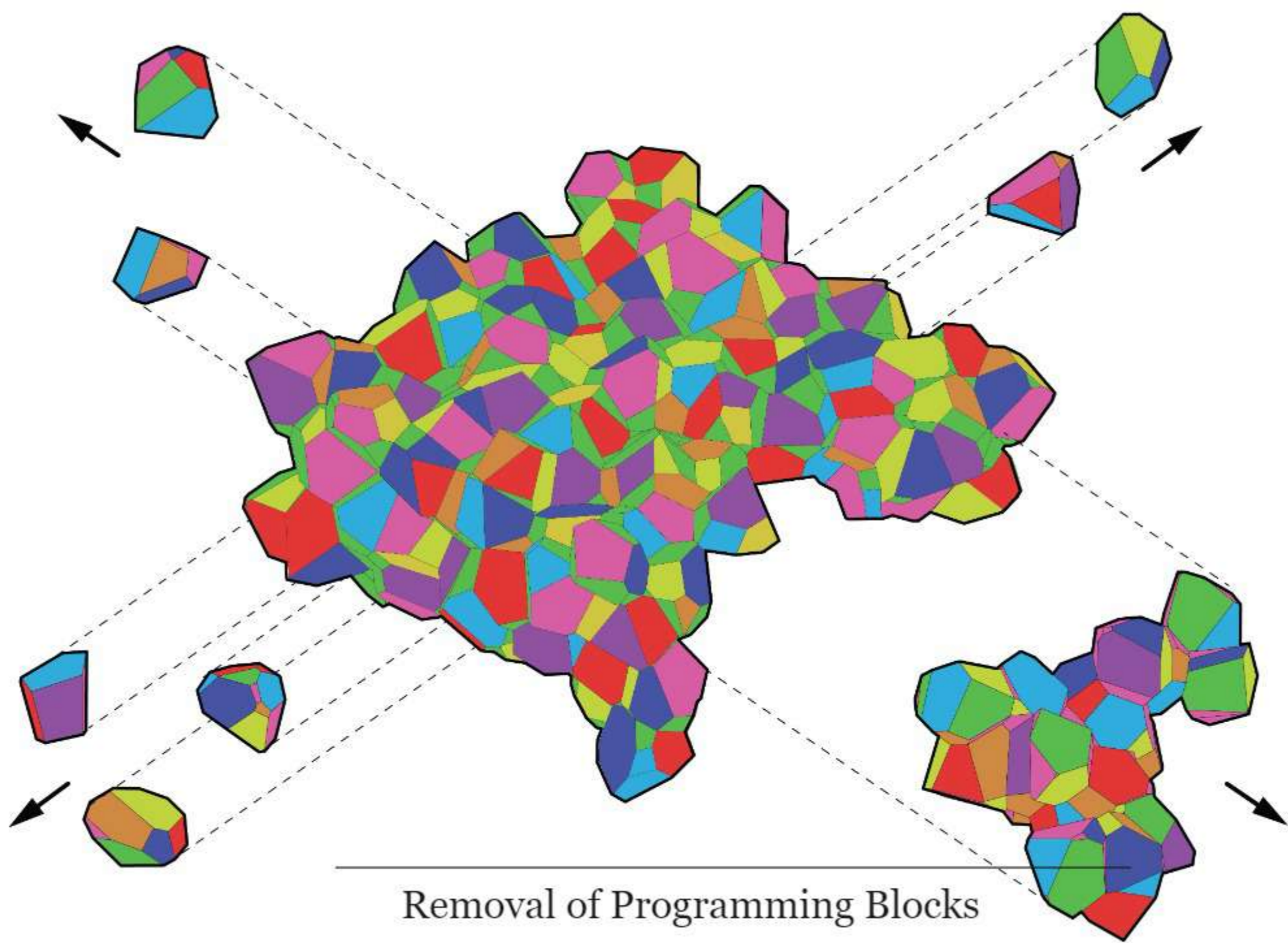

Removal of Programming Blocks

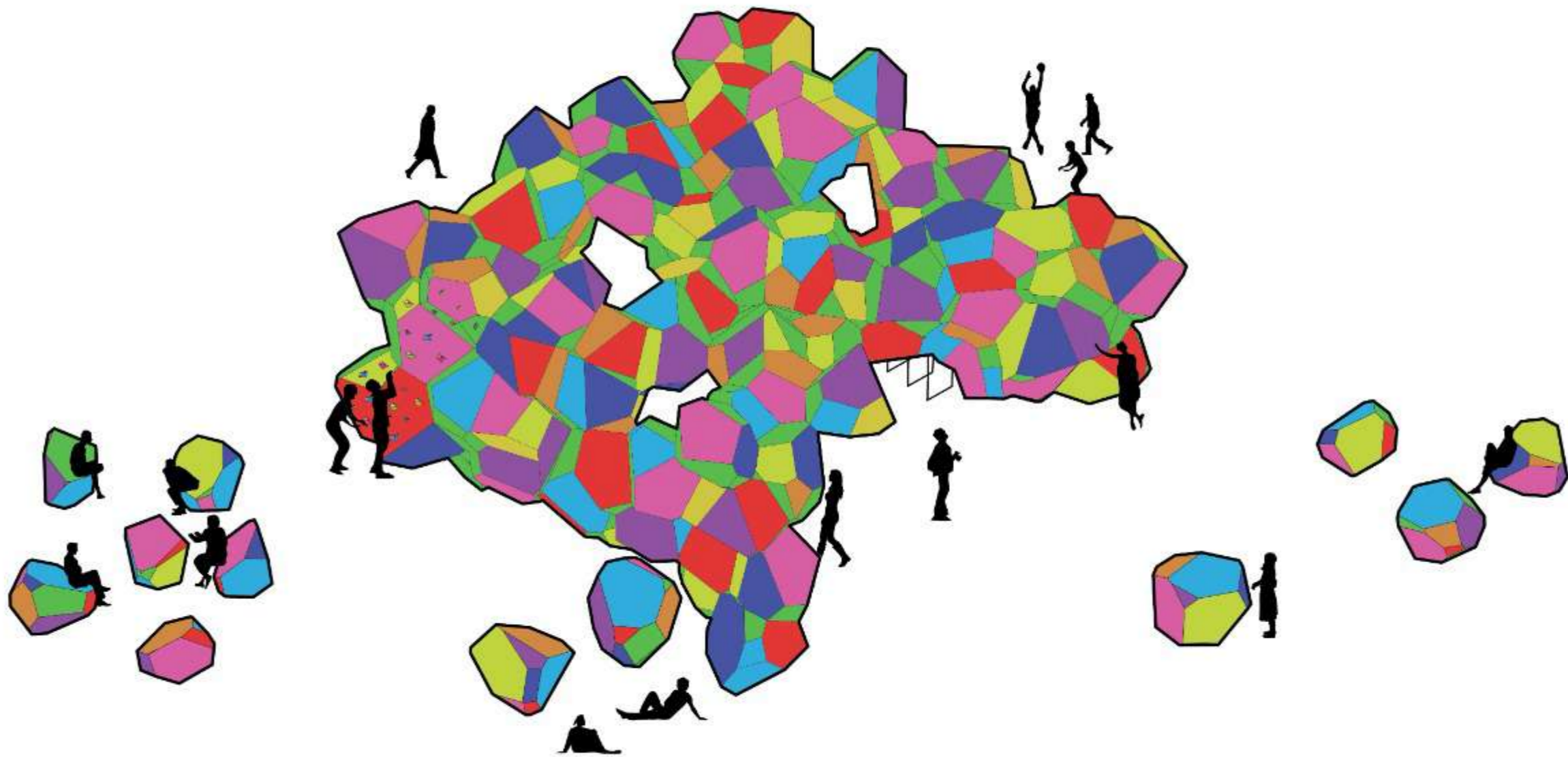

Final Design



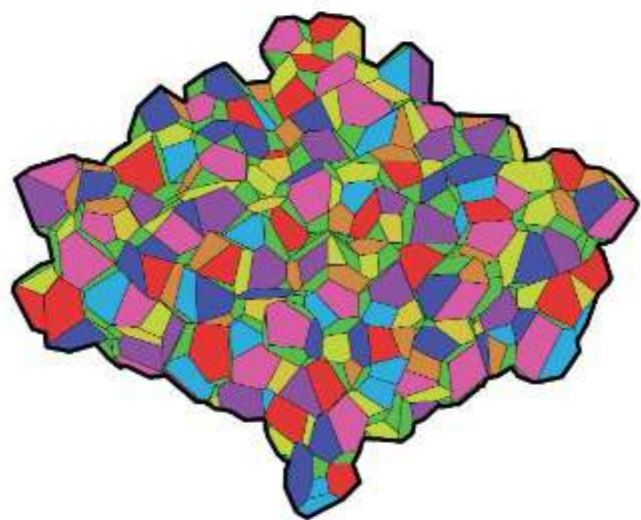

**Closed**

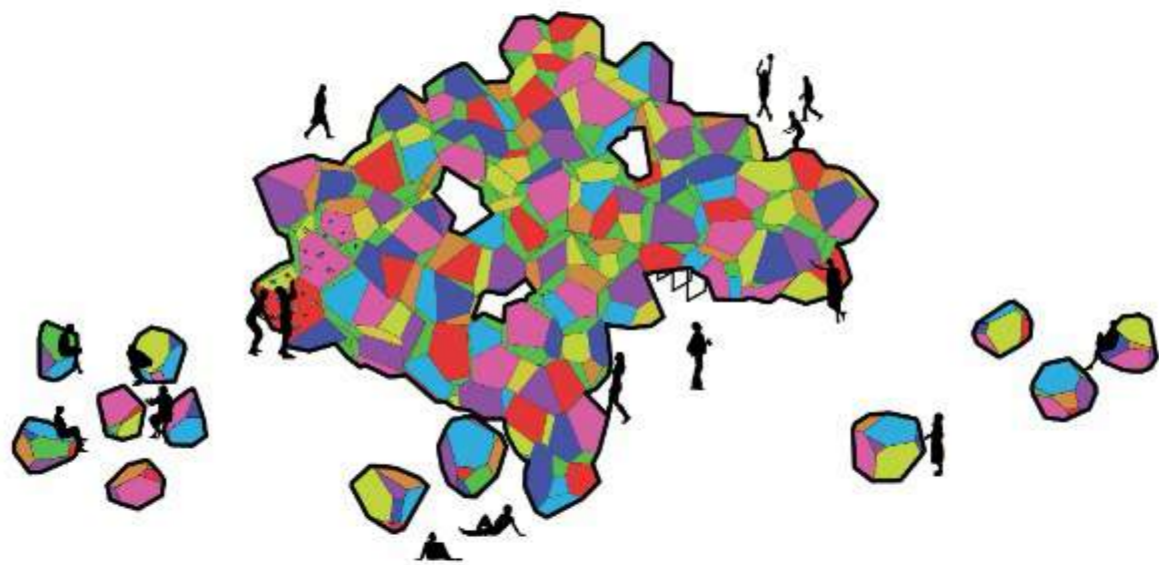

**Open**

---

Final Design

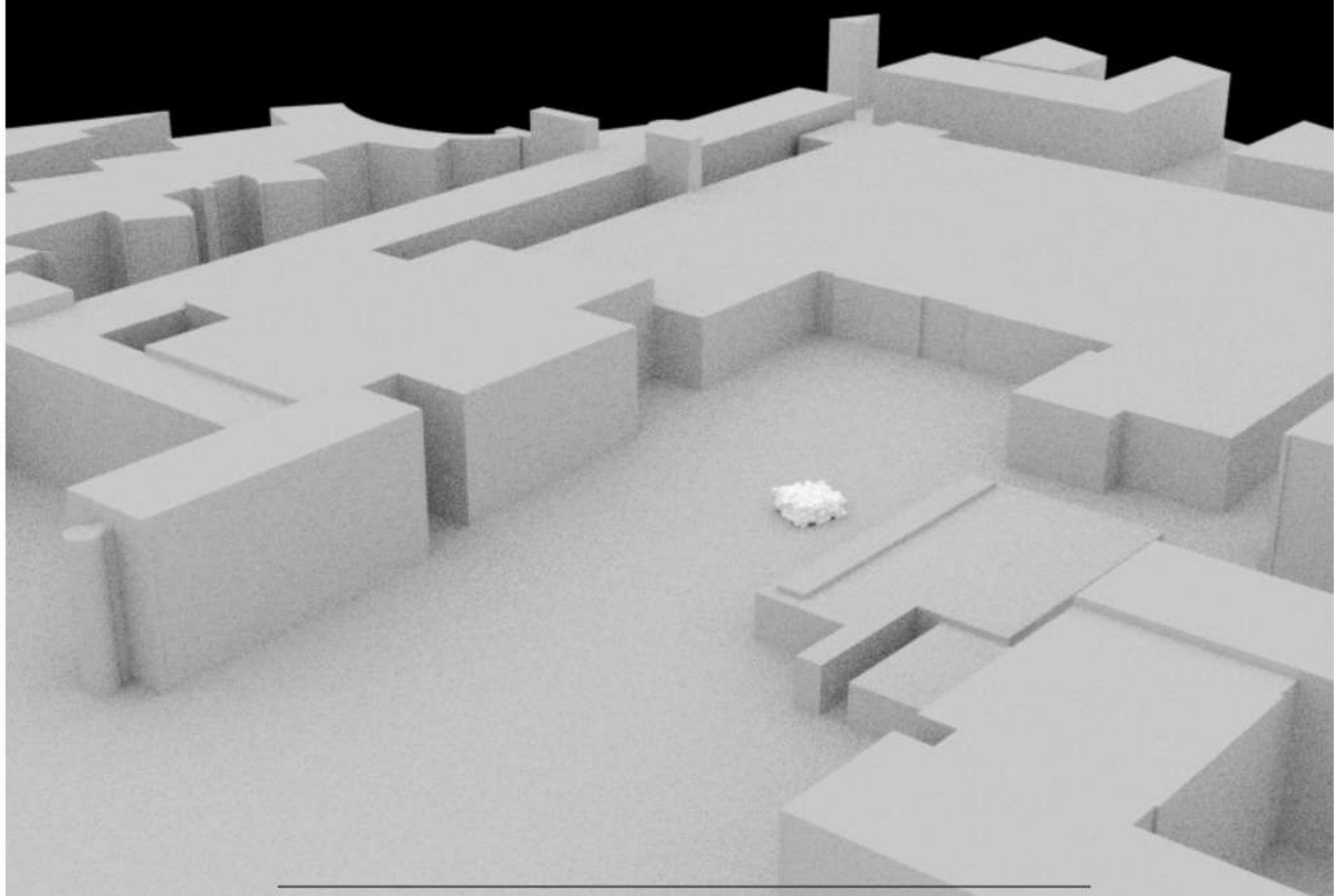

---

Context

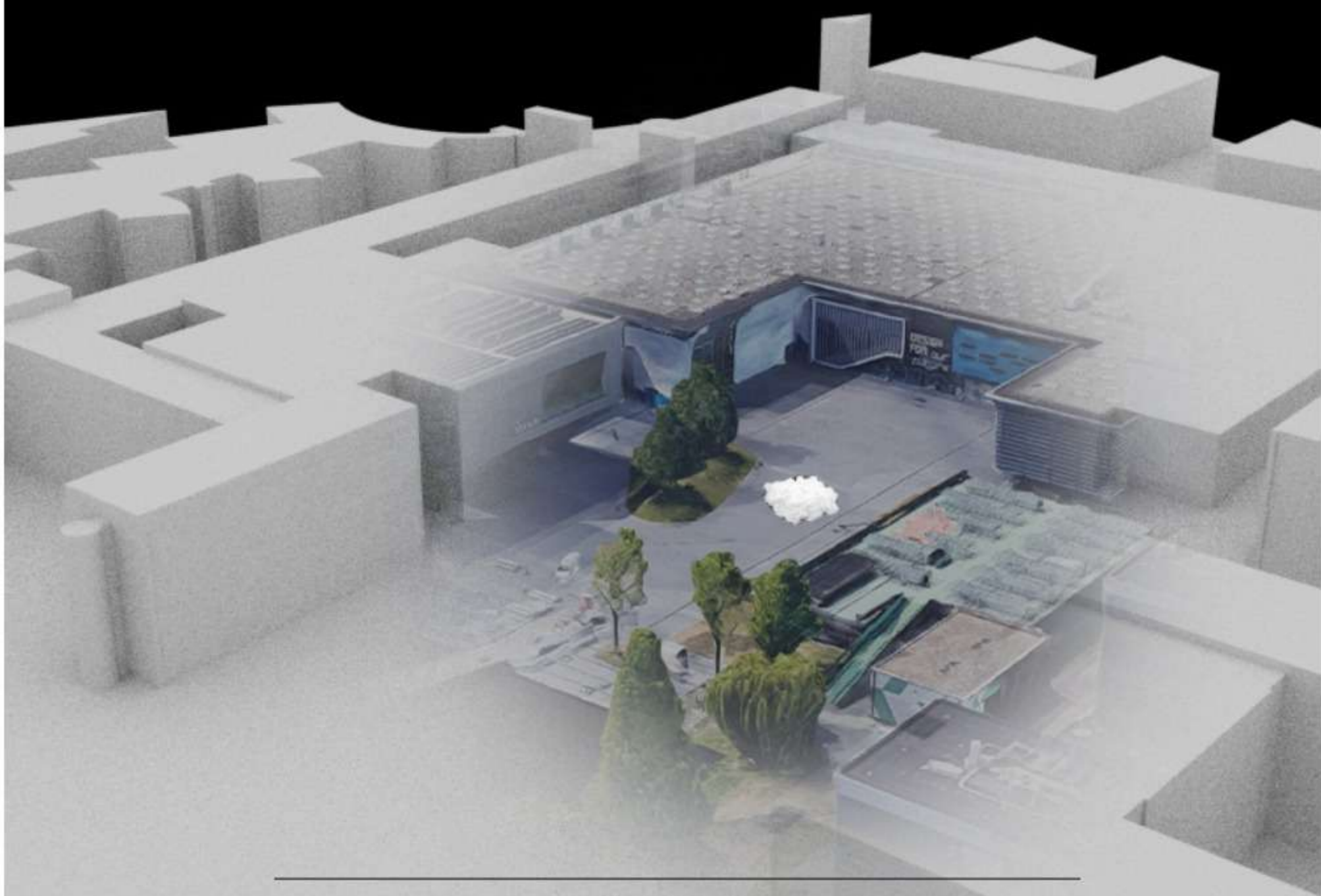

---

Context





IDE Square View

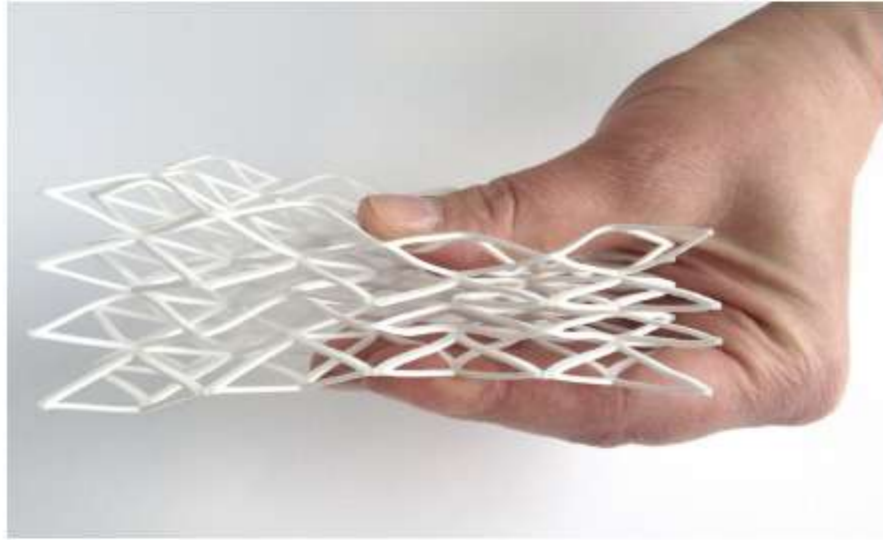

flexible rubber-like material

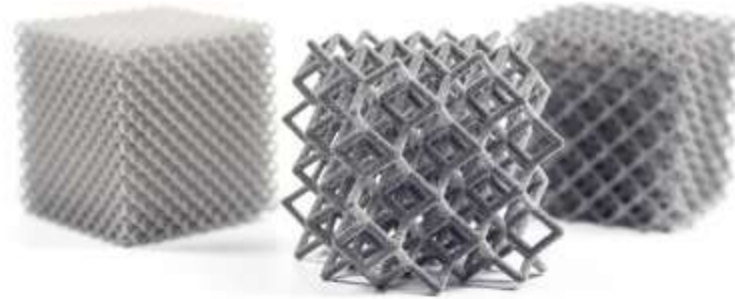

3D voronoi structure



3D printed  
leightweight  
adjusting to the user

---

Material



color identification

70 - 100 cm

can be rotated

3D voronoi structure

adjustable

50 - 90 cm

leightweight

modules can be linked  
for more users

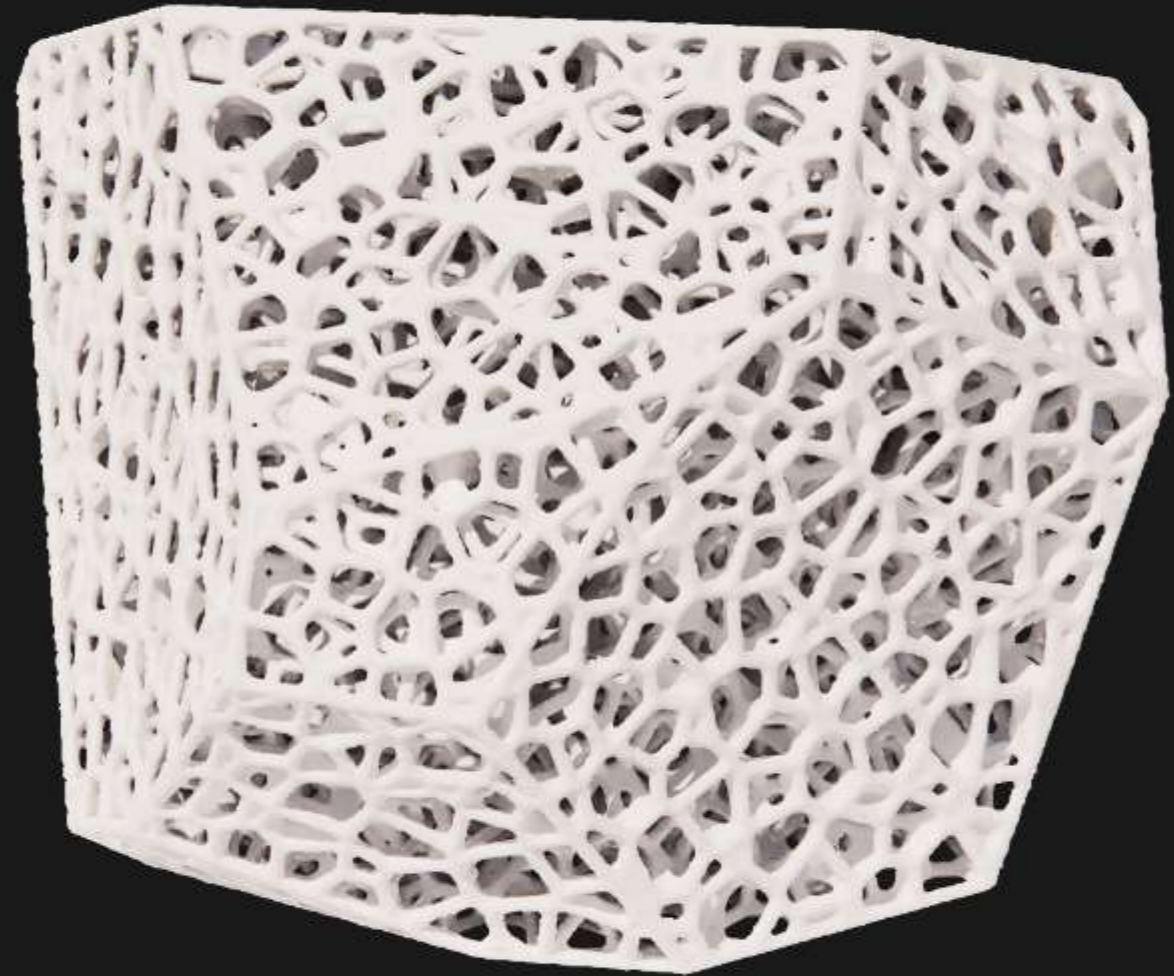

The cell



color identification

70 - 100 cm

can be rotated

3D voronoi structure

adjustable

50 - 90 cm

modules can be linked  
for more users

leightweight

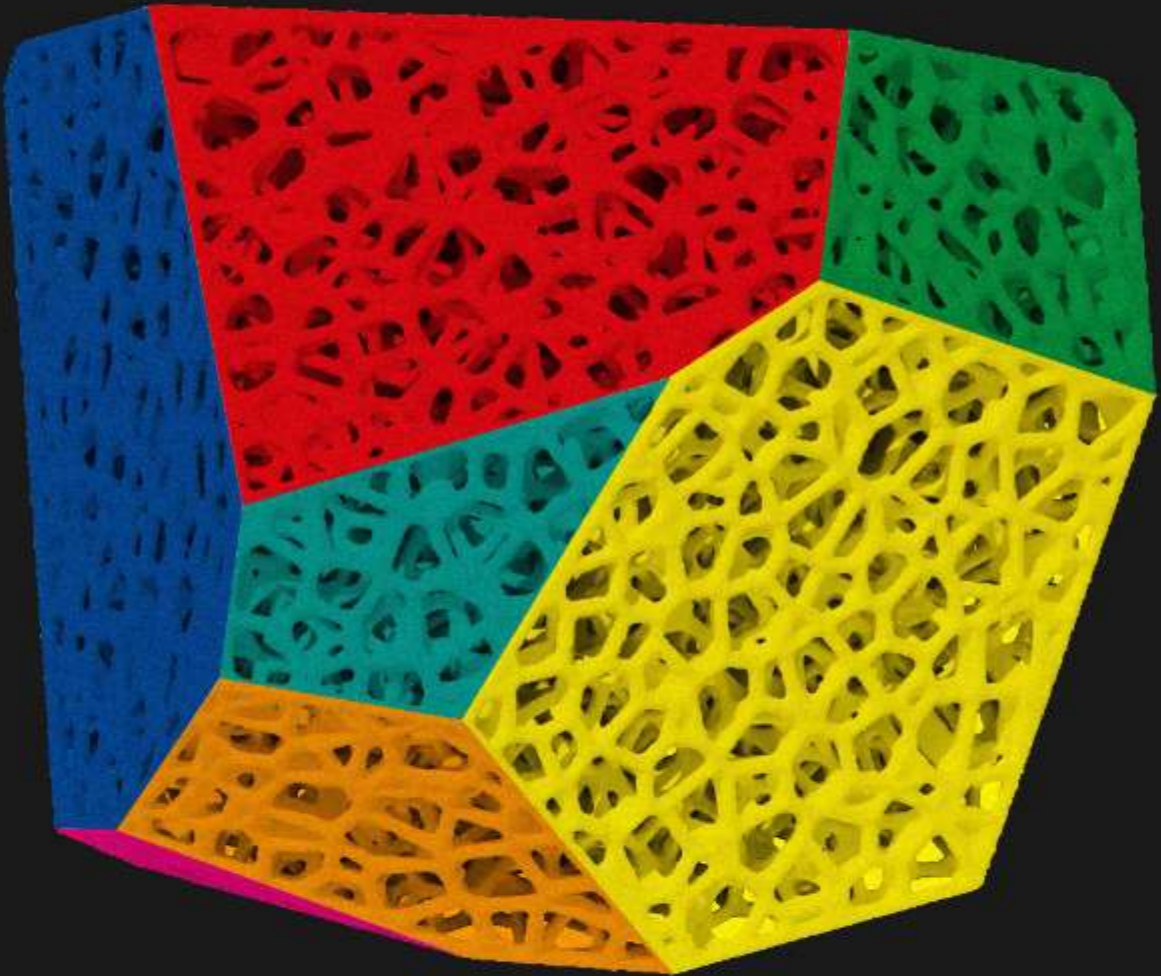

The cell

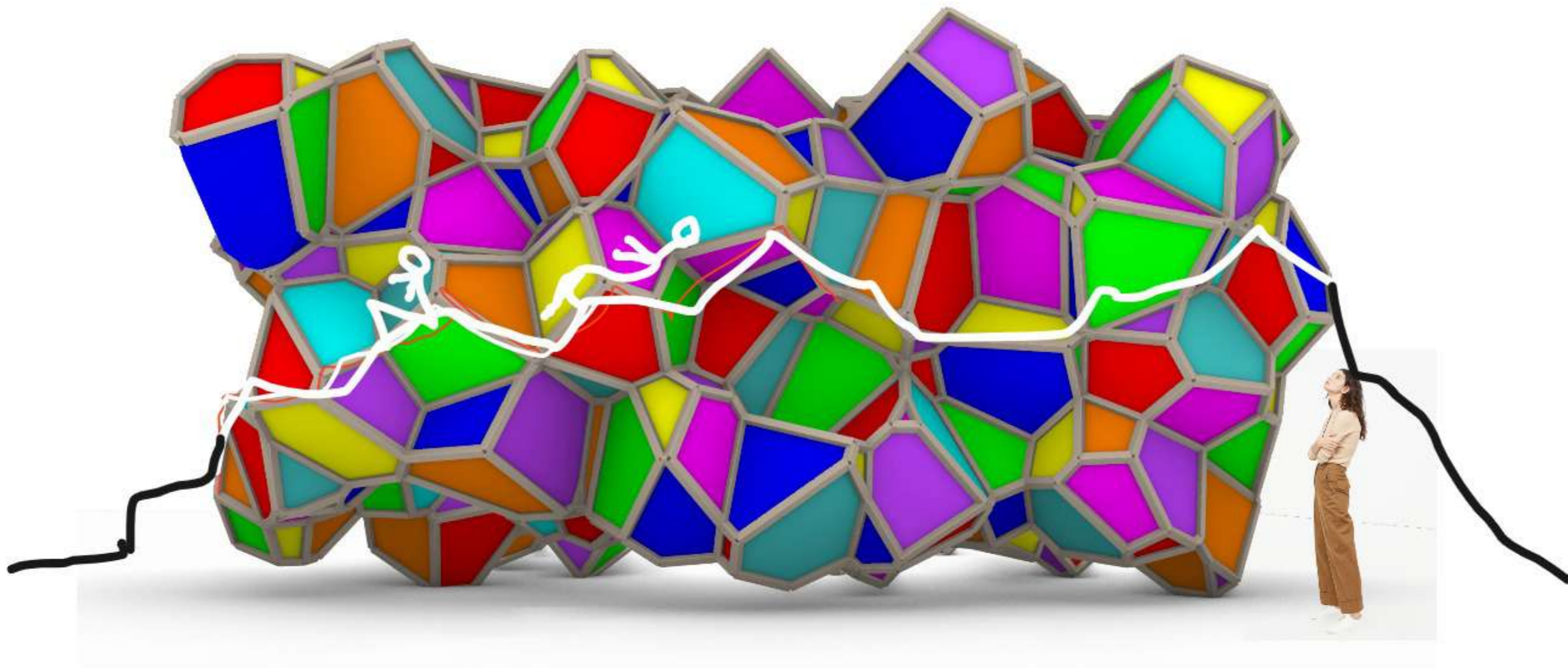

---

Front view



---

Name of the slide